



WAREWASH ACCESSORIES

ULTRA ACTIVE®.....21

SINGLE SINKMATE.....22

DUAL SINKMATE.....23

SINKMATE FAUCET ADAPTER KIT.....24

DRAIN CLEANER DISPENSER.....25

DRAIN CLEANER DISPENSER.....26

FREEDOM SYSTEM™ SPECIALTIES.....27

GLADIATOR SPECIALTIES.....28

FAUCET FEEDERS AND PUMPS.....29

260 RINSE INJECTOR AND 217C DETERGENT INJECTOR.....30

INJECTION FITTINGS.....31

COPPER FITTINGS AND PROBES.....32

WAREWASH ACCESSORIES.....33

THERMAL SENSOR PROBE.....34

WAREWASH ELECTRICAL REPLACEMENT PARTS.....35

BRACKETS, SHELVES AND STAND.....36



ULTRA ACTIVE[®] SPECIALTIES DISPENSER 4055105



No.	Description	Part No.
1	Ultra Active [®] Specialties Dispenser	4055105
2	Water Level Stickers	014125



SINGLE SINKMATE

3161707



No.	Description	Part No.
1	Single Sink Mate	3161707
2	Dema Metering Tip Set	014333



DUAL SINKMATE

015434

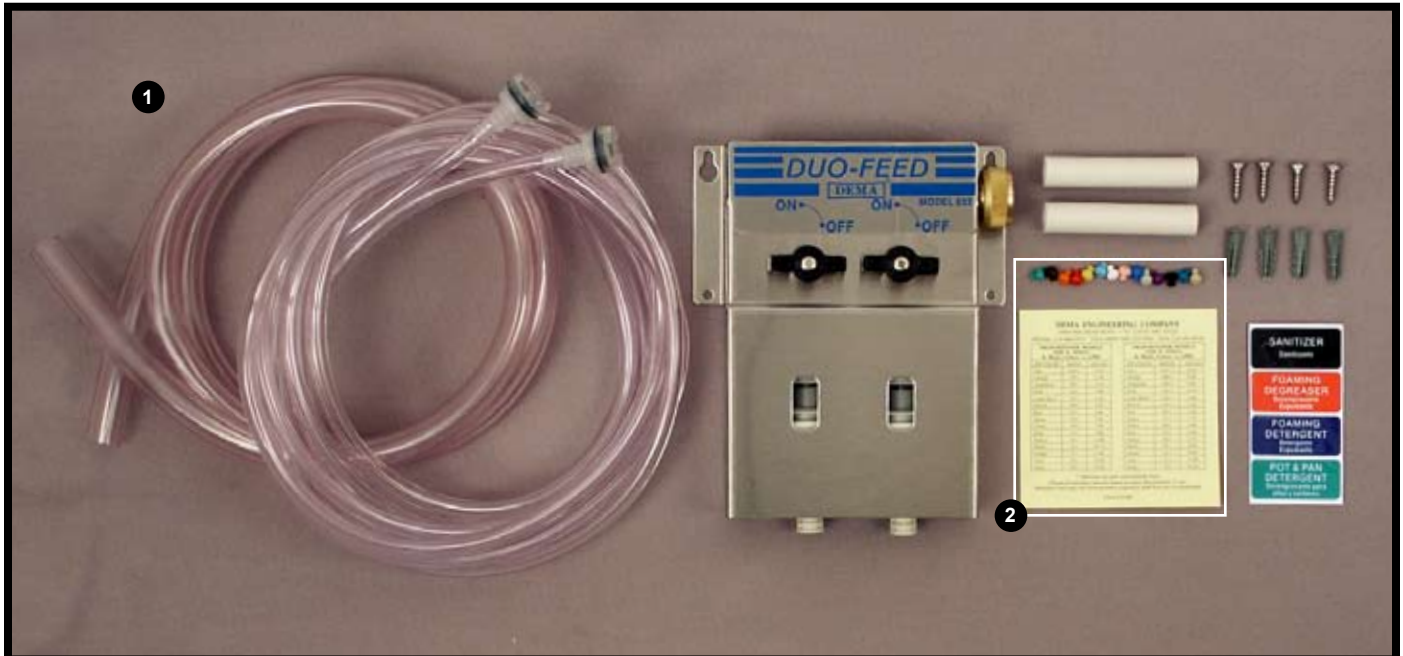

No.	Description	Part No.
1	Dual Sink Mate	015434
2	Dema Metering Tip Set	014333



SINKMATE FAUCET ADAPTER KIT

015435



No.	Description	Part No.
1	Sinkmate Faucet Adapter Kit	015435



DRAIN CLEANER DISPENSER

BATTERY OPERATED 4114646

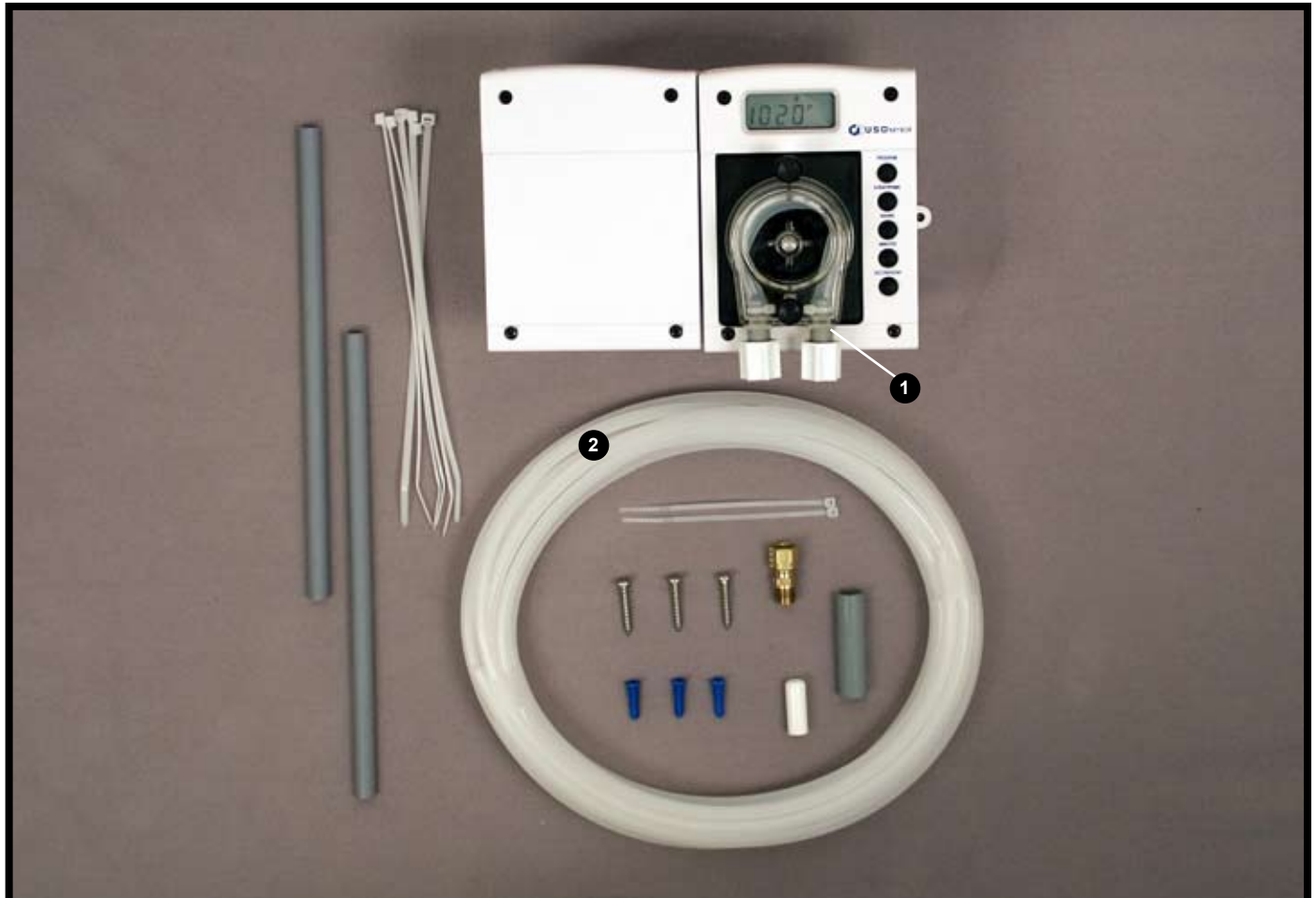

No.	Description	Part No.
1	Black EPDM Tube For Snap Head	058550
2	1/4" Polyflow Per Foot	011385



DRAIN CLEANER DISPENSER

4114654

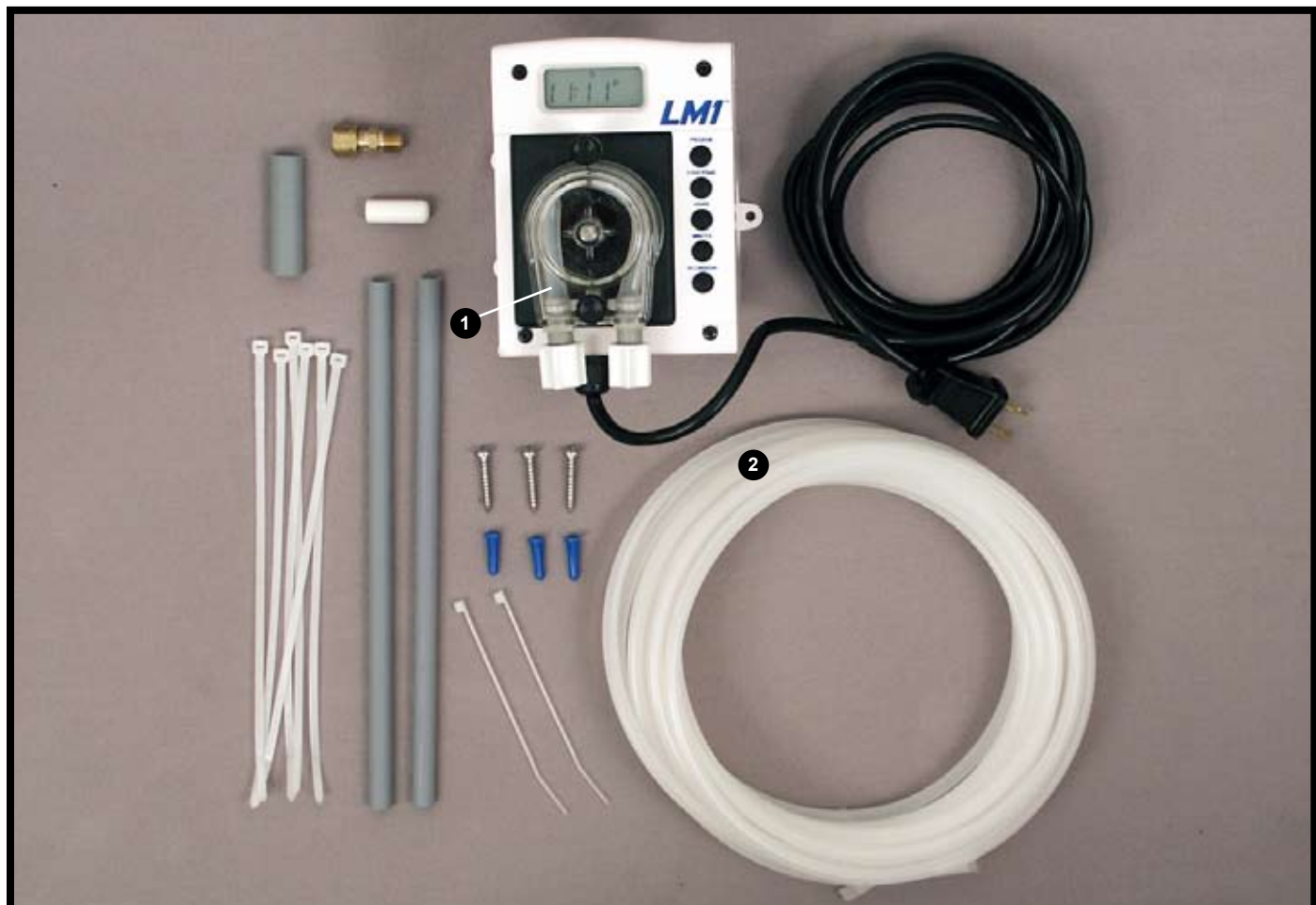

No.	Description	Part No.
1	Black EPDM Tube For Snap Head	058550
2	1/4" Polyflow Per Foot	011385



FREEDOM SYSTEM™ SPECIALTIES
014541

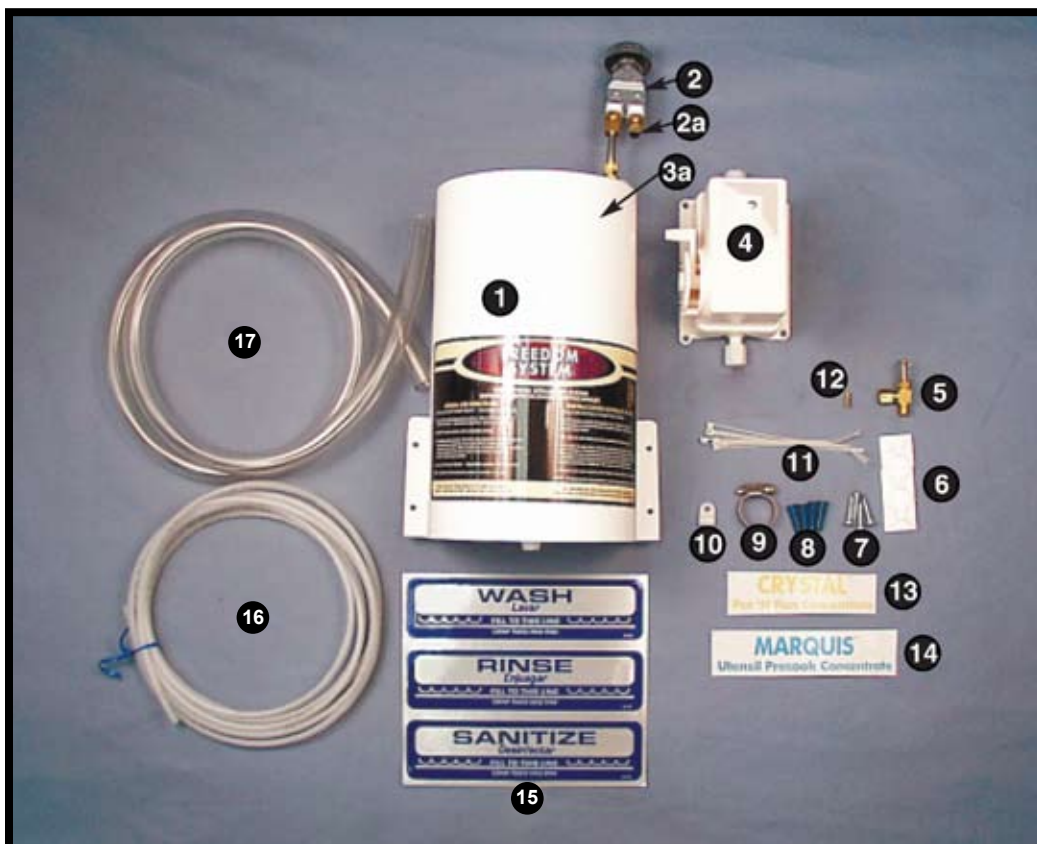

No.	Description	Part No.
1	Specialty Retro "Only"	014716
2	Replacement Vacuum Breaker Assembly	014467
2a	Brass 1/4" Nut w/Poly Sleeve	011462
3	Spray Arm Assembly w/Vacuum Breaker	014450
3a	Spray Arm Assembly "Only"	014449
4	Mechanical Timer (0-1) Minute	011492
5	1/4" CC x 1/8" NPT Needle Valve	011372
6	Large Adhesive Wire Saddle	011037
7	Sheet Metal Screw 10 x 1	011704
8	Wall Anchor	011705
9	S.S. 1 1/16" Hose Clamp	014183
10	1/4" Wire Clamp	011039
11	6" Pull Tie (Per 100 Bag)	011015
12	1/4" Brass Tube Support	011437
13	Crystal Film	011981
14	Marquis Film	011980
15	Water Level Set	014125
16	1/4" Polyflow Tube (Per Foot)	011385
17	5/8" ID x 7/8" OD PVC Overflow Tube (Per Foot)	011460



GLADIATOR SPECIALTIES
014648

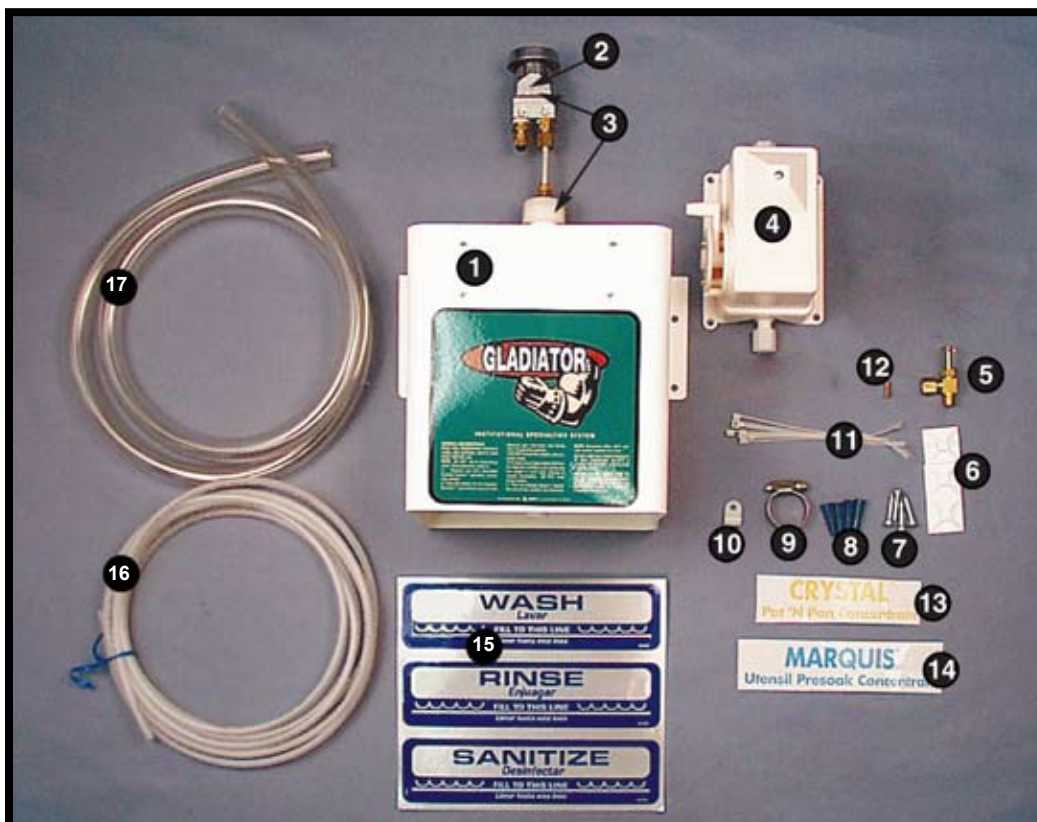

No.	Description	Part No.
1	Gladiator Specialty Retro Only	014762
2	Replacement Vacuum Breaker Assembly	015137
2a	Brass 1/4" Nut w/Poly Sleeve	011462
3	Spray Arm Assembly w/Vacuum Breaker	014475
3a	Spray Arm Assembly "Only"	014476
4	Mechanical Timer (0-1) Minute	011492
5	1/4" CC x 1/8" NPT Needle Valve	011372
6	Large Adhesive Wire Saddle	011037
7	Sheet Metal Screw 10 x 1	011704
8	Wall Anchor	011705
9	S.S. 1 1/16" Hose Clamp	014183
10	1/4" Wire Clamp	011039
11	6" Pull Tie (Per 100 Bag)	011015
12	1/4" Brass Tube Support	011437
13	Crystal Film	011981
14	Marquis Film	011980
15	Water Level Set	014125
16	1/4" Polyflow Tube (Per Foot)	011385
17	5/8" ID x 7/8" OD PVC Overflow Tube (Per Foot)	011460



FAUCET FEEDERS AND PUMPS

FAUCET FEEDERS



No.	Description	Part No.
1	152 Faucet Feeder Push Button	014242
2	154 Faucet Feeder w/Vacuum Breaker Push Button	014244
3	167 Faucet Feeder with Slide Bar	014243

WALL PUMPS



No.	Description	Part No.
4	616 Pot n' Pan Soap Dispenser 1 Ounce	014337
5	301 C Chlorine Dispenser 1 Ounce	014265
6	301 B Pot n' Pan Soap Dispenser 1 Ounce	014240

JUG PUMPS

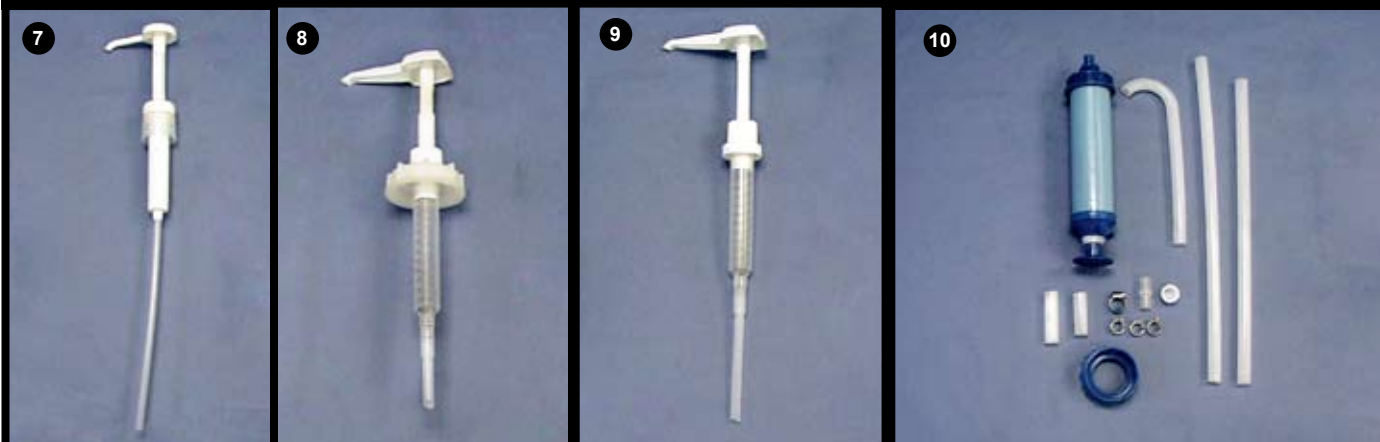

No.	Description	Part No.
7	P101 Five Gallon Pail Pump (1 Ounce)	014245
8	2 1/2 Gallon Jug Pump (1/2 - 1 Ounce)	014315
9	P102 one Gallon Jug Pump (1 Ounce)	014246
10	P104 PVC Pump 5/15/30/55 Gallon (2-8 Ounce)	014247



260 RINSE INJECTOR AND 217C DETERGENT INJECTOR

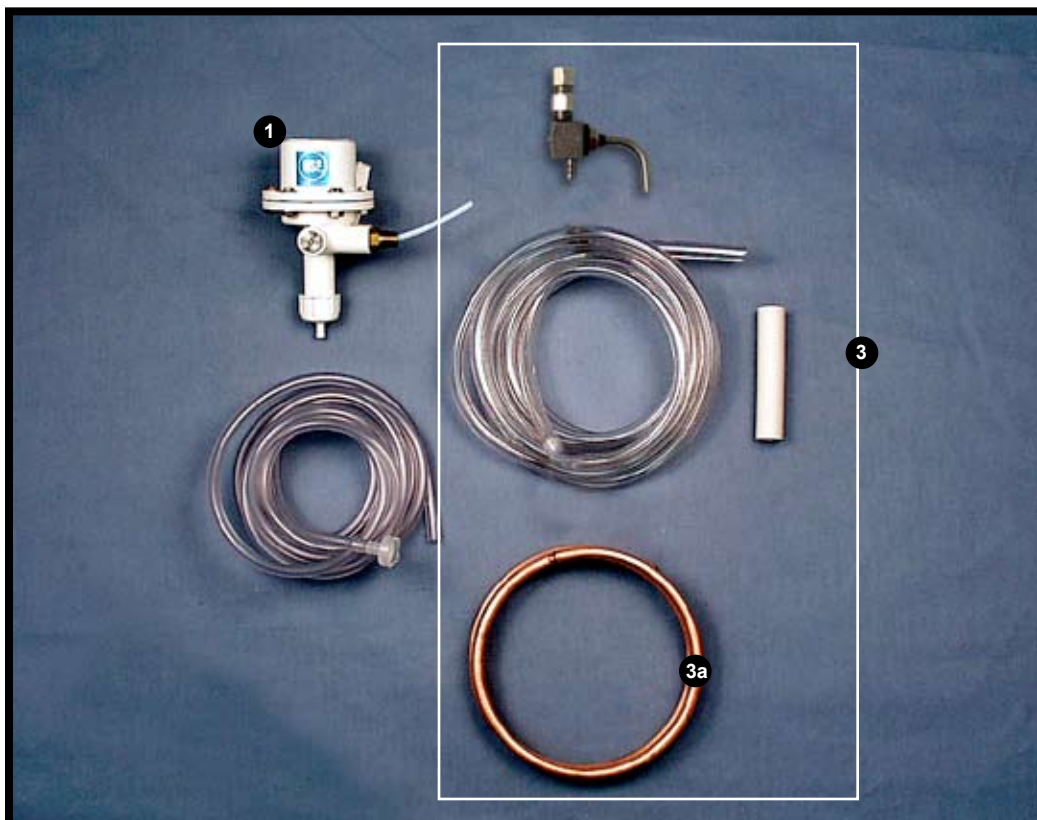

No.	Description	Part No.
1	260 Hydraulic Rinse Injector Complete	014504
2	Kit For Remote Mount 260 (Not Pictured)	011501
3	217C Hydraulic Detergent Injector Complete	011758
3a	Copper Tubing Per Foot	011380



INJECTION FITTINGS



No.	Description	Part No.	No.	Description	Part No.
1	Rubber Overflow Washer (W.W. Detergent/Liberty Powder)	011701	9a	3/16" Brass Nut & Sleeve Replacement for Above Fitting	011408
2	Plastic Overflow Washer (W.W. Detergent/Liberty Powder)	011723	10	1/4" Poly Check x 1/4" Poly x 1/8" NPT Injection Fitting	011674
3	Basin Nut (W.W. Detergent/Liberty Powder)	011702	11	3/8" Tube Support (Warewash Detergent)	011436
4	Angle Overflow Barb (Liberty Powder)	011389	12	1/4" Poly x 1/8" NPT Nylon Straight	011414
5	3/8" Poly x 1/2" MPT Parker Straight (Warewash Detergent)	011430	13	Saddle Clamp Brass	011377
6	1/4" Hose Barb (Vinyl Tubing)	011429	14	S.S. 3/16" Poly x 1/8" NPT Straight Rinse Complete	011432
7	1/4" Poly x 1/8" NPT Checkvalve Injection Fitting Nylon	011675	14a	S.S. 3/16" Nut for Above Fitting	011469
8	S.S. 1/4" Poly x 1/8" NPT Checkvalve "Rinse Only"	011550	14b	S.S. 3/16" Sleeve for Above Fitting	011475
9	3/16" Poly x 1/8" NPT Brass Straight "Rinse"	011407			

COPPER FITTINGS

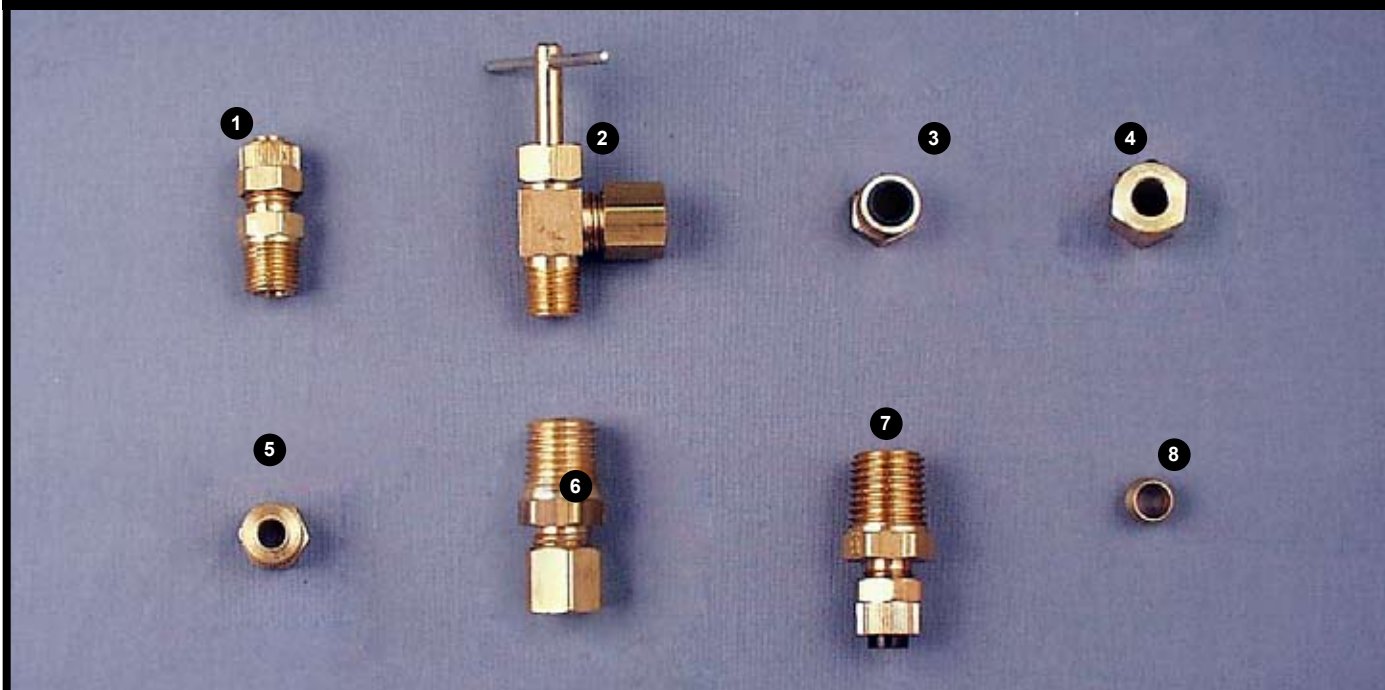

No.	Description	Part No.
1	Brass 3/16" Poly x 1/8" NPT (Rinse)	011407
2	1/4" CC x 1/8" NPT Needle Valve	011372
3	1/4" Poly Sleeve w/Brass Nut	011462
4	1/4" Compression Nut	011458
5	3/16" Sleeve and Nut (For Rinse Fitting 011407)	011408
6	1/4" CC x 1/4" MPT Brass Straight (Solenoid/Vacuum Breaker)	011374
7	1/4" Poly x 1/4" MPT Brass Straight (Solenoid/Vacuum Breaker)	011397
8	1/4" Compression Sleeve	011456

PROBES



No.	Description	Part No.
1	Button Probe	011770
2	Spark Plug Probe	011754
3	Bayonet Probe	011761



WAREWASH ACCESSORIES

No.	Description	Part No.	No.	Description	Part No.
1	Remote Pressure Switch	011771	3	5 gallon stand pipe w/ float switch	014498
2	Rinse Line Thermal Sensor	3668461	4	1 gallon stand pipe w/ float switch	014497

No.	Description	Part No.	No.	Description	Part No.
5	DE Circuit Board	4121168	8	1/4" poly x 1/8" npt S.S. Check Valve	011550
6	1/4" poly x 1/8" npt Check Valve - Nylon	011675	9	Button Probe	011770
7	1/4" poly Check x 1/4" poly x 1/8" npt Y Fitting	011674			



THERMAL SENSOR PROBE (for DE)

011836

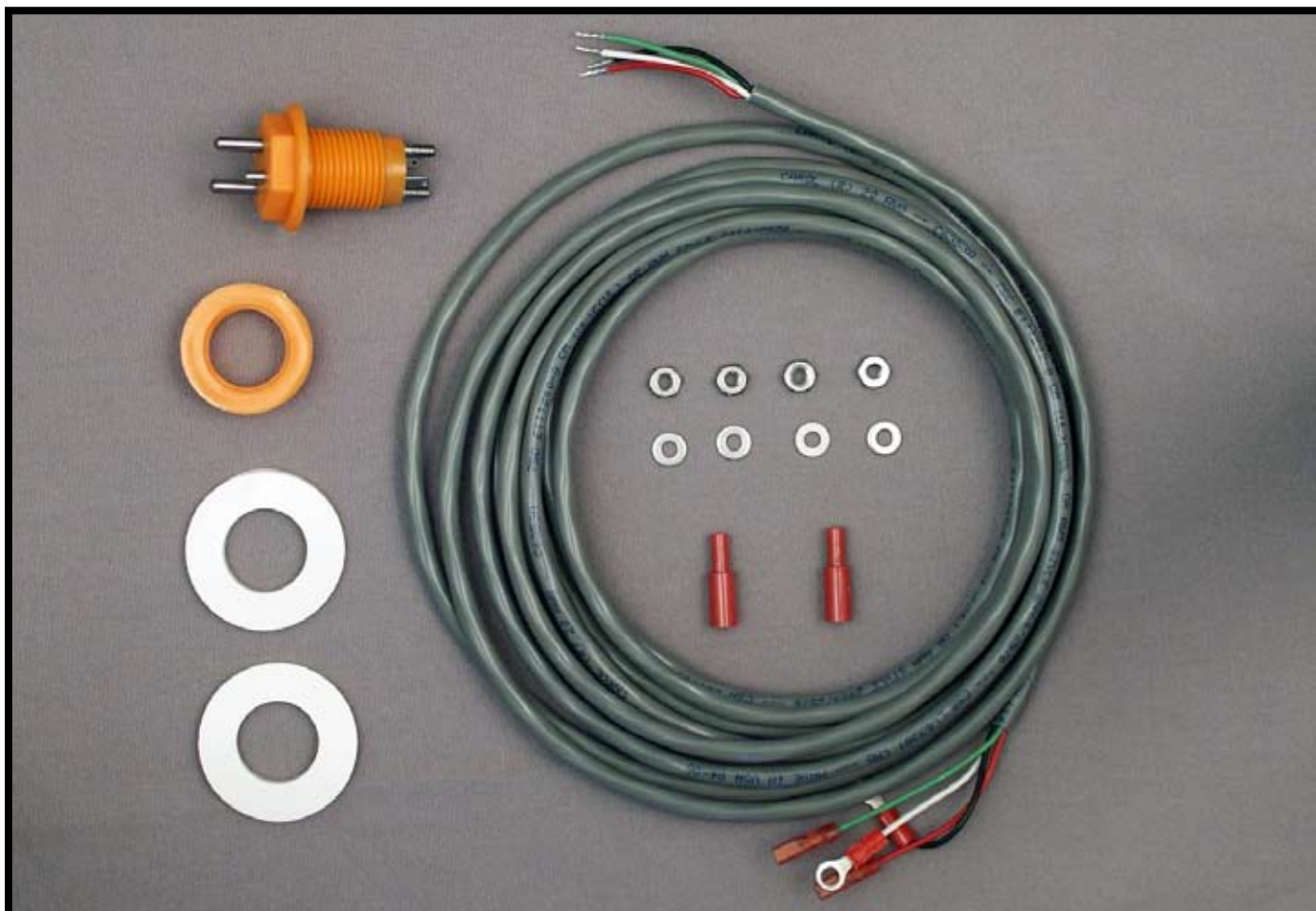

No.	Description	Part No.
1	Thermal Sensor Probe (for DE)	011836



WAREWASH ELECTRICAL REPLACEMENT PARTS

No.	Description	Part No.	No.	Description	Part No.
1	24V. D.C. 100 RPM Motor With Bridge	011735	3	440 to 120V. Step Down Transformer	011002
2	24V. D.C. 28 RPM Motor (Lib./W.W. Rinse & Sanitizer)	3033140			

No.	Description	Part No.	No.	Description	Part No.
4	Solenoid Repair Kit	011590	6	1/4" poly x 1/4" mpt Brass Straight (Polyflow Line)	011397
5	Solenoid, 24V DC (unassembled, for DE)	3719301	7	1/4" cc x 1/4" mpt Brass Straight (Copper Line)	011374

BRACKETS, SHELVES AND STAND

BRACKETS

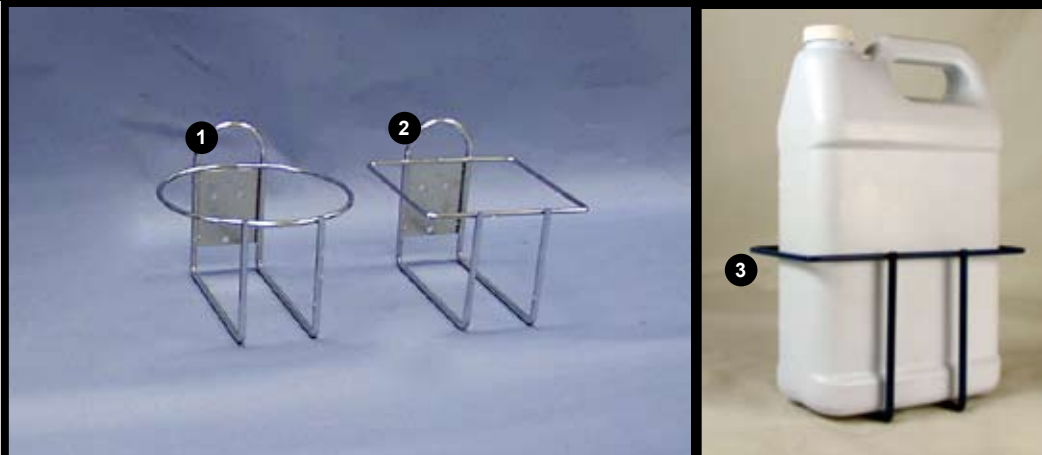

No.	Description	Part No.
1	Round 1 Gallon Bottle Bracket	011835
2	Square 1 Gallon Bracket	011759
3	Rectangle 1 Gallon Bracket	4385999

LOCKING SHELVES

FREEDOM STAND



No.	Description	Part No.
1	2-Product Locking Shelf for 1 Gallon Square Bottles	011931
2	3-Product Locking Shelf for 1 Gallon Square Bottles	011932
3	Lock and Key (Supplied w/Shelf)	014236
4	Freedom/Warewash Mounting Bracket	011910